

HPE Visual Remote Guidance (VRG)

Audio video features

Quick reference guide

Audio video tools available by default

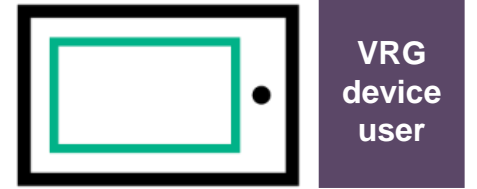

Microphone Speaker Webcam

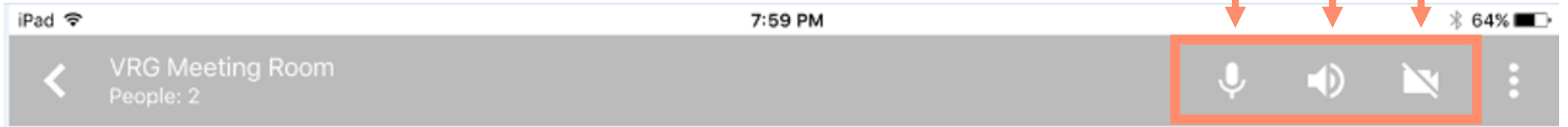

Tap an icon on the toolbar to turn that audio video feature on or off

Video toolbar available when webcam is on



VRG
device
user

Switch camera:

- If VRG device has both front and back cameras

Snap:

- Upload snapshot from VRG device's webcam to content panel

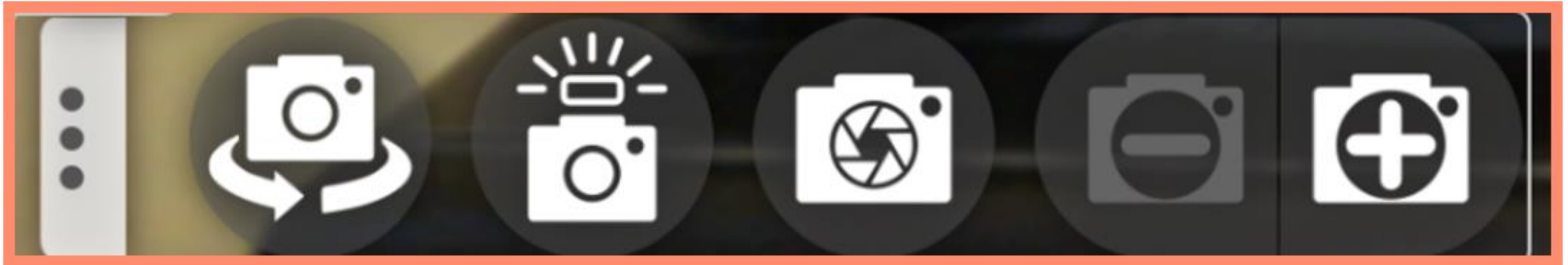

Light:

- If VRG device has a flashlight, light up streaming video

Zoom:

- Enabled if VRG device's back camera supports zoom

Snap

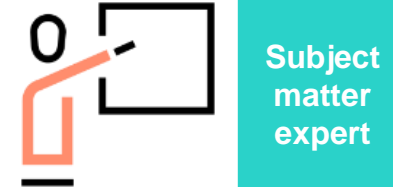
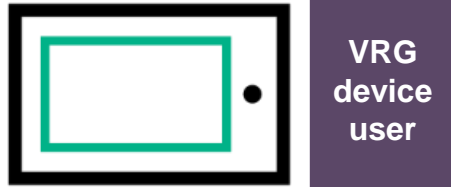

- Tap **Snap** icon
- Snapshot is uploaded from VRG device's webcam to room's content panel

- Display and annotate snaps in center viewing area
- Help direct VRG device user
- Use as training material

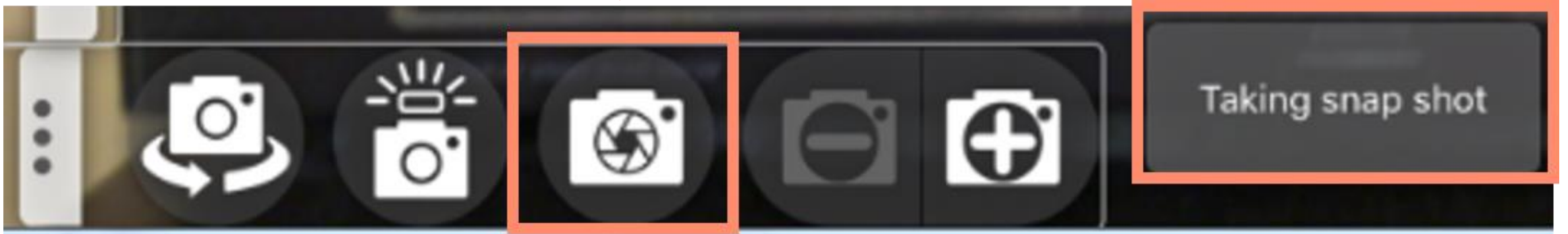

Switch between thumbnail and center stage



VRG device user

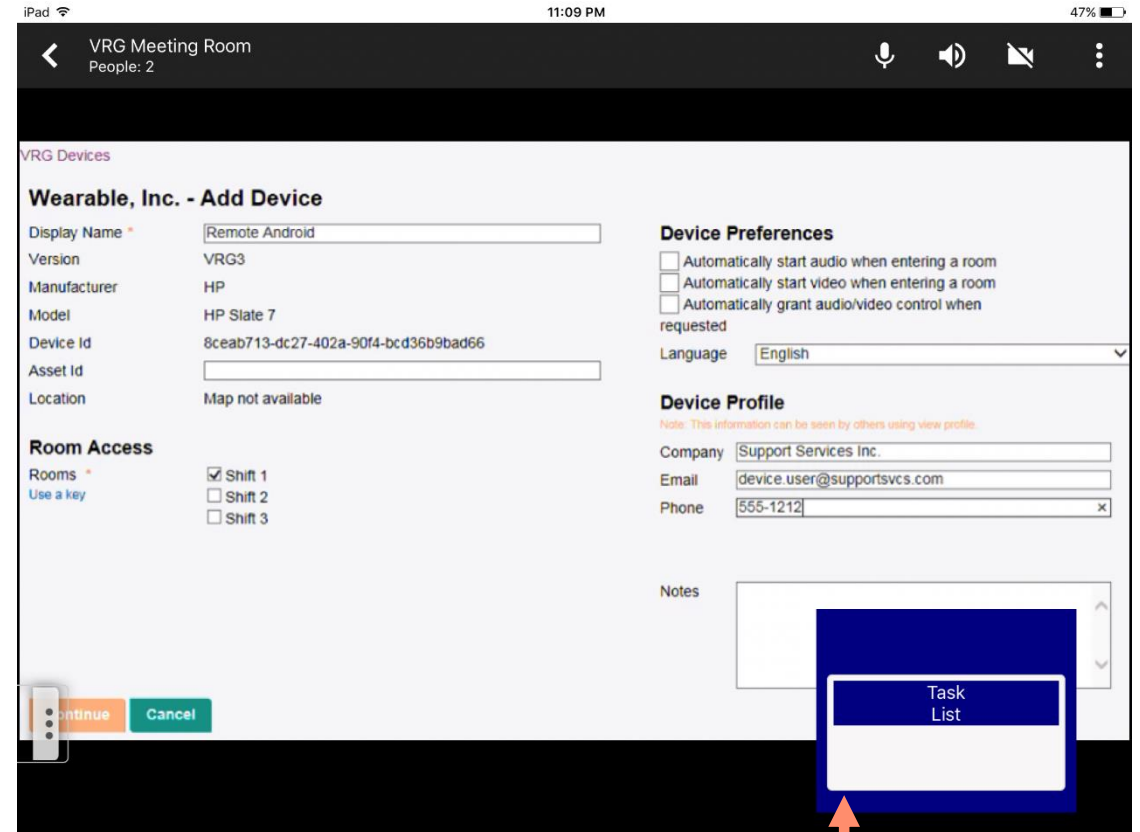
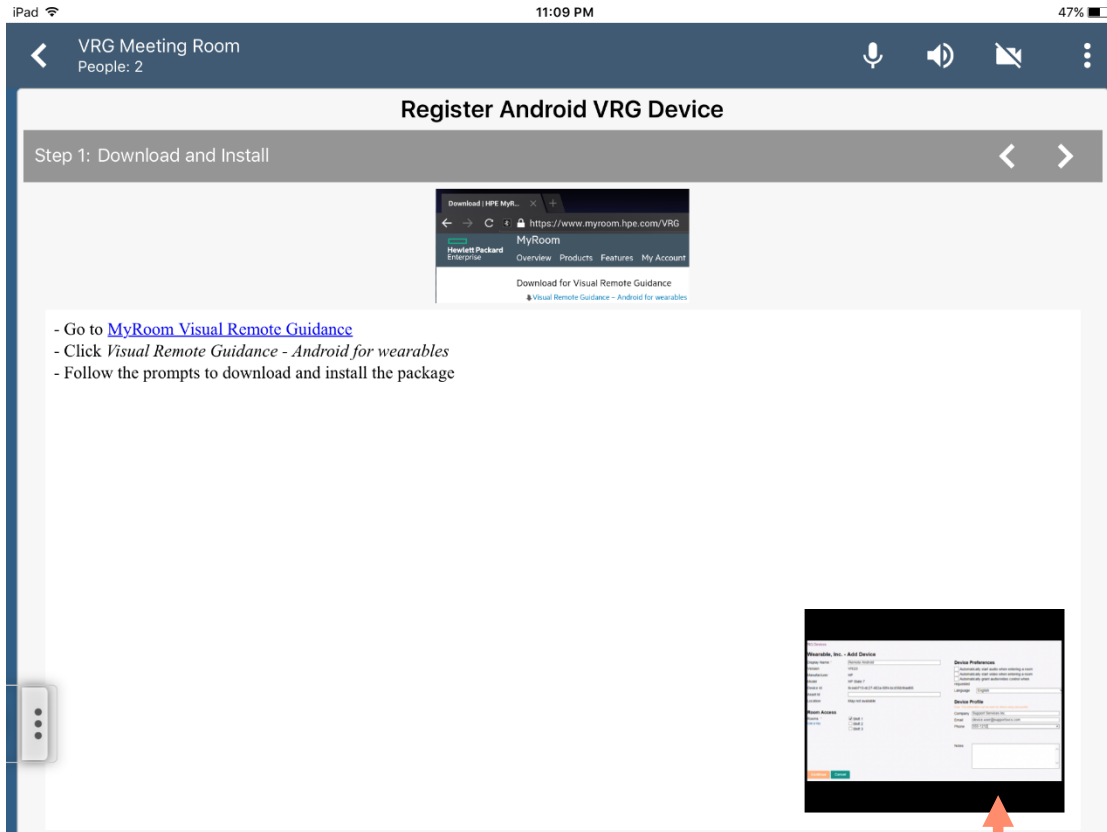

Tap thumbnail to move it to center stage

Request audio video control

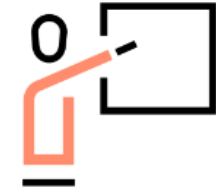

Subject
matter
expert

- Right-click VRG device user in People panel
- Select **Request Audio Video Control** from menu

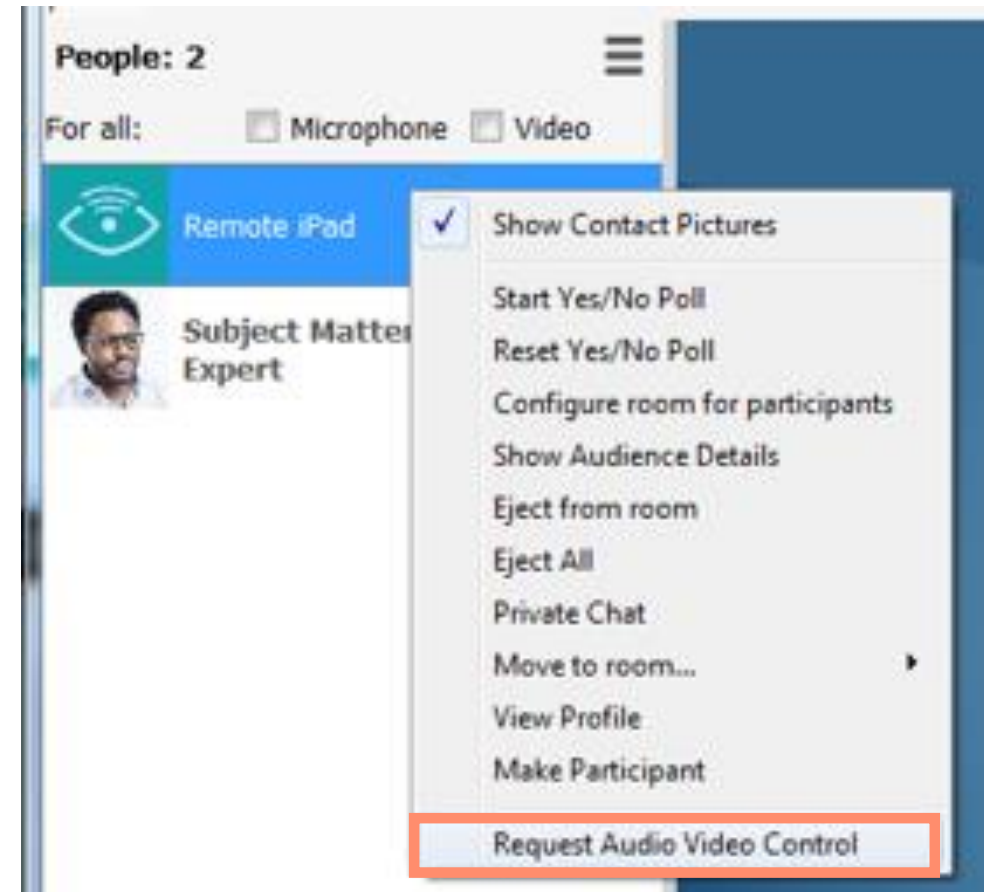

Use remote audio video control

Allow VRG device user hands-free operation of VRG device

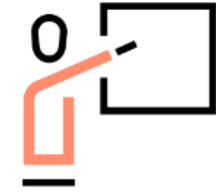

Subject
matter
expert

Click icon to turn on/off:

- Microphone
- Speaker
- Webcam

Check to turn flashlight on/off

Click to take snap

Click to end control of VRG device

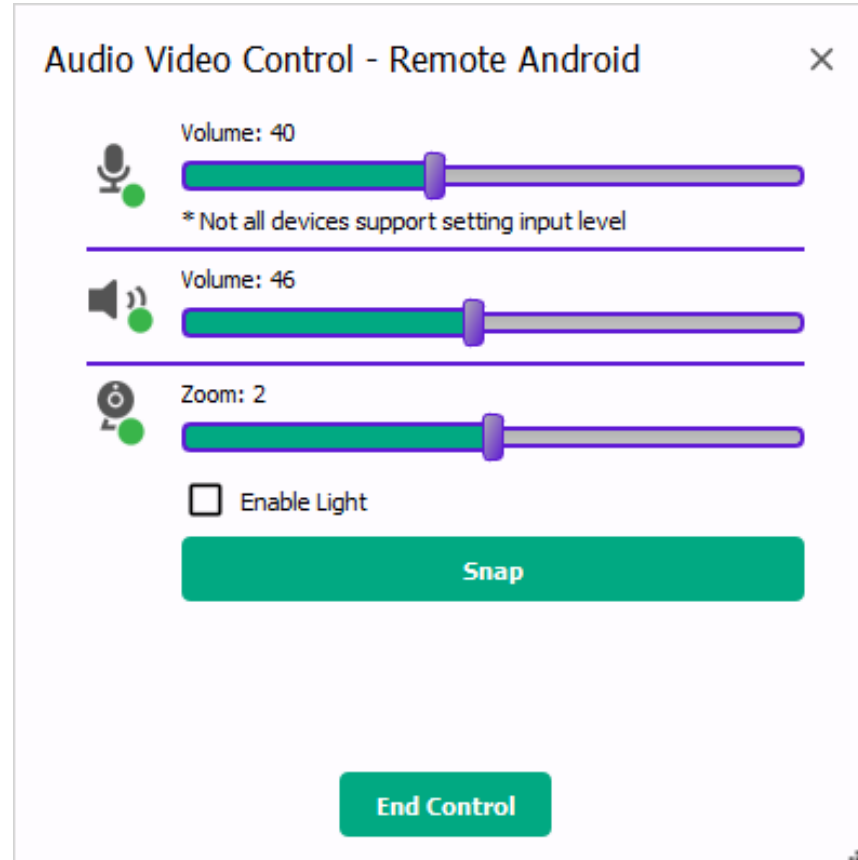

Sliders:

- Adjust microphone volume
- Adjust speaker volume
- Zoom webcam